

Duro 4.5 Pressure Sensitive Labeler

Description

The Duro 4.5 Pressure Sensitive Labeling machine is truly versatile. It is fully automatic and can be permanently mounted vertically for top-down/bottom-up labeling or horizontally for side labeling. As an option, we

Duro 4.5 on Mobile T-Base Stand



offer a T-Base Stand with locking casters for mobile labeling capability.

The Duro 4.5 web provides superior label placement control. It automatically detects the object to be labeled and, after an adjustable delay, dispenses the label against the product. After the label is separated from the peel plate, a follower arm utilizes either a sponge rubber roller or a brush to wipe the label. The PLC Operator Interface provides timing control through an LCD screen. It also provides a product counter that can be reset.

The Duro 4.5 Labeler is able to provide superior performance while remaining affordable and well within the reach of most packagers.



Duro 4.5 Operational Controls

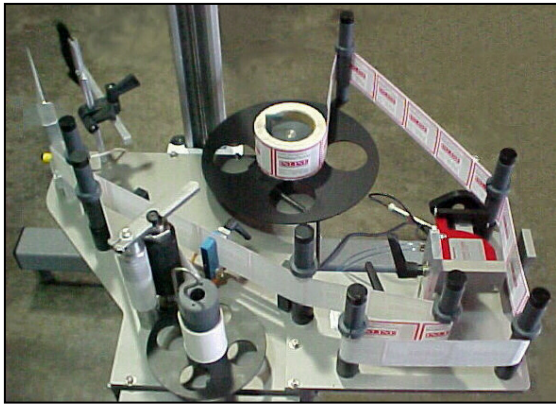

Duro 4.5 Labeling Head shown with Ink Stamp Coder

Specification

- Speed: Up to 100 ppm
- Labeling Head motor: 1/8 hp variable speed DC drive
- Labeling Head dimensions: 19" x 19"
- Labeling Head weight: 60 pounds
- Power requirements: 120 volt AC, 60 cycle, 5 amp power
- Compressed air: 3-4 cfm @ 65 psi if required

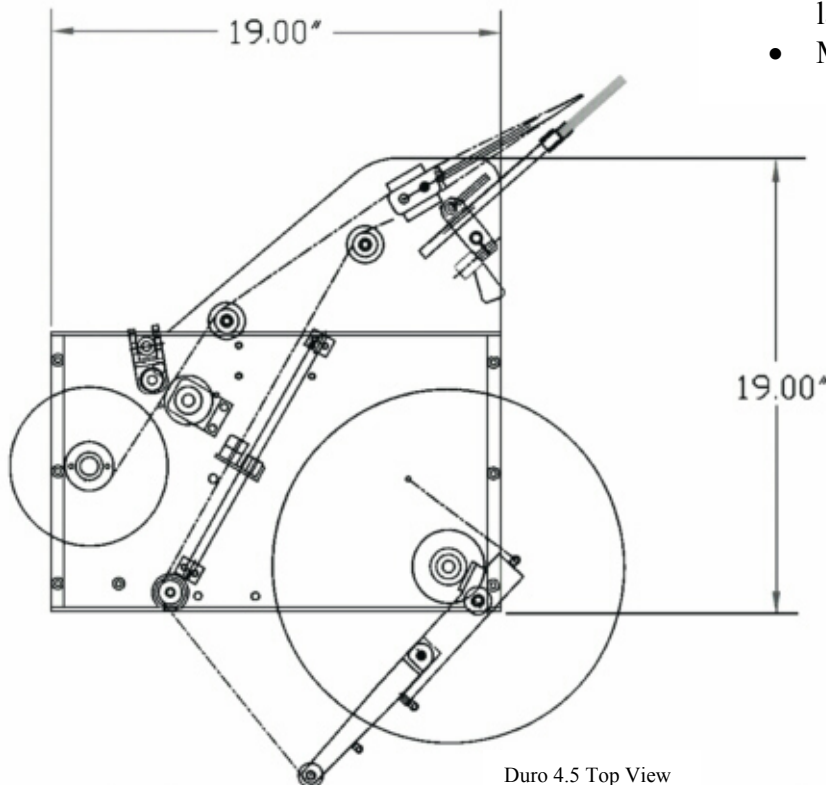

Duro 4.5 Top View

Features

- Apply labels from 1" to 4 1/2" tall and 14" long.
- Accommodates conveyor speeds up to 1000 ipm with a maximum rate of 100 labels per minute.
- Recognizes 1/8" standard to 1/4" label gap.
- Accepts 12" label roll and industry standard 3" diameter core.
- Photoeye product detection and photoeye gap detection.

Options

- Hot Stamp coding for lot/date information.
- Servo motor/drive provides input for a pulse train that allows automatic "following" of the label speed to the product conveyor.
- Stepper motor/drive provides finer control of label dispensing speed.
- Mobile T-Base Stand with locking casters.

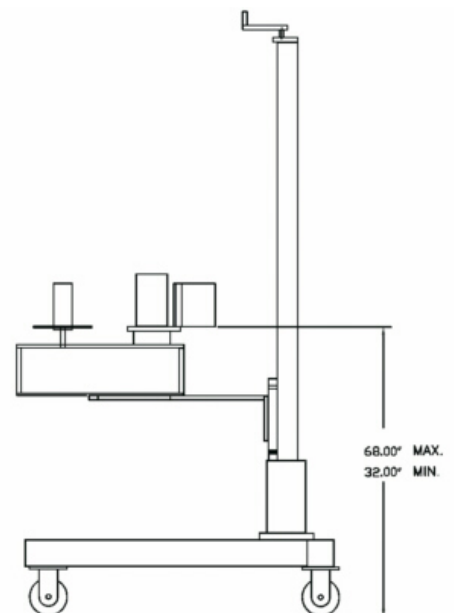

Mobile T-Base Stand – Side View